



**Knowledge Base:** [multitech.com/kb.go](http://multitech.com/kb.go)  
(800) 972-2439 or (763) 717-5863

Diagram illustrating the components of the MultiTech 1000 system, numbered 1 through 10:

1. Main unit (MultiTech 1000)
2. Coaxial cable
3. Antenna
4. Power adapter
5. Mounting plate
6. Mounting bracket
7. Battery pack
8. Remote control
9. Infrared receiver
10. Infrared transmitter

- 
- Model: MTCAN-LN3  
 BUD: 915-941-MT18X  
 ORDER P/N: MTCAN-915-941-MT18X SLZO  
 SKU # 70005090L DOM 2023.01.10  
 Serial # 2  
 Powered with 5V 1.0 and auto-detects components  
 Power Requirements 5V 1.0A  
 IMEI: 454611000000000  
 Ethernet MAC: 98:6E:00:00:00:00  
 FCID: 01/7920/13A19861  
 IC: C04-1908  
 Contains FCC: R17L93N0AVZ  
 Contains CE: C01A-1930N0A2  
 LORA NODE: 00  
 UUID: 00-00-00-00-00-00-00-00  
 SIM #

- Username: **admin**  
Password: **Admin[serial number]**

## Installing the MultiTech App and Creating a Console Account

To manage and monitor sensors, you need a Radio Bridge Console account. The MultiTech App simplifies connecting your MTCAP and sensors to the console. To get the app and create an account:

1. Download and install the MultiTech app  from the App Store or Google Play.
2. Open the app. If you don't have a Radio Bridge Console account, tap **Create one here**. The app opens a browser to the Radio Bridge Console.
3. Enter your **First Name**, **Last Name**, **Email**, and **Password**. **Re-enter Password** to confirm it.
4. Check to agree with **Terms and Conditions** and tap **Register**.
5. After you receive the confirmation email, click **Confirm Account** in the email to activate your account. Then, return to the MultiTech app and log in with your console account credentials.

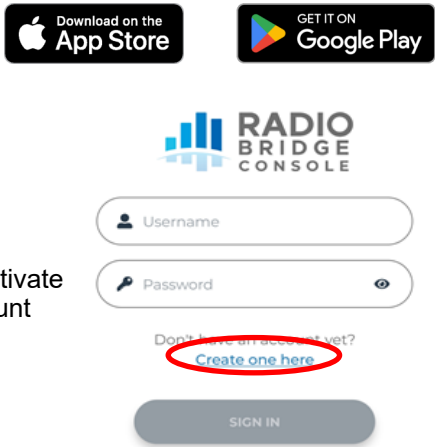

## Registering the MTCAP Gateway

When the STATUS LED is ready (blinking) on the MTCAP, register the gateway through the app.

1. Tap **Gateways** and then tap **Add**.
2. Tap **Chirpstack**.
3. Tap the camera icon on the Add Gateway screen and scan the **EUI QR code** on the device. The EUI QR code is on a small sticker on the MTCAP not the main product label.
4. Enter Gateway Details to register the gateway. Region is detected automatically from the device.
  - **Gateway Name** to identify the gateway.
  - **IP address: 192.168.2.1**
  - **Description** to describe the gateway.
5. Tap **Save**.
6. Tap **Finish** to add the gateway to the console.

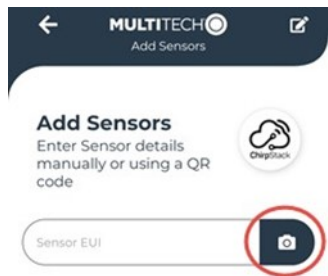
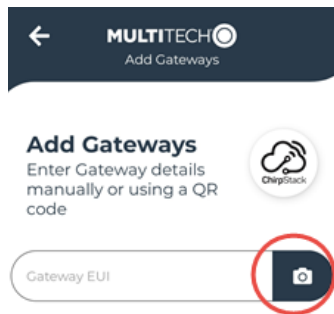

## Adding Sensors

To register sensors through the MultiTech app:

1. Tap **Sensors** and then tap **Add**.
2. Tap **Chirpstack**.
3. Enter a **Sensor name**. The app increments this by one for each sensor of the same type.
3. Tap **Save**.
4. Tap the camera icon to scan the **QR code** on the device's yellow key card (in the sensor's package).
5. For some sensors, the app prompts you to select a region and sensor type.
  - Select **EU868** for Europe or **US915** for North America.
  - Select the sensor type. The OneBox sensors are at the top of the list.
6. Tap **Next**. On the **Add Sensors** page, tap the **Finish**.
7. Repeat these steps for each sensor.



## Preparing Sensor Hardware

Sensors ship with batteries installed. There is a plastic tab over the battery, which needs to be removed. Pull the tab out of the sensor to connect the battery. If the tab does not pull out easily, you may need to open the case to remove it.

To open the case:

1. Use a pen or similar object to press the button on the opposite side of the case.
2. Remove the battery tab. You may need to remove the battery to remove the tab.
3. Re-insert the battery and close the case.

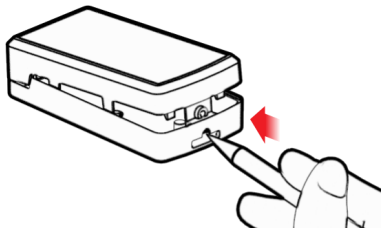

To open the Single Push Button sensor:

1. Loosen screws and lift the back slightly.
2. Remove the battery tab.
3. Close the case and hand-tighten the screws. Do not overtighten.

To remove the battery tab from the Air Temperature Humidity Sensor

1. Turn the mounting bracket counterclockwise to remove it from the sensor.
2. Remove the battery tab.
3. Reattach the mounting bracket.

## Mounting Sensors

Use the included large adhesive pad with a sensor to secure the case in position.

For increased security, open the case, and fasten it to the wall using the included tamper screw as shown. Then reassemble the case. The tab will break away and send a tamper alert if the case is forcibly removed.

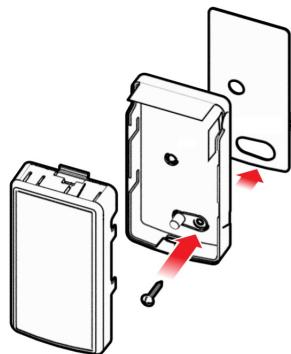

### Mounting Window/Door Sensors

For the Window/Door Sensor, mount the sensor on the door or window frame with the notch facing the door or window as shown.

Attach the magnet piece to the door or window so it aligns with the notch.

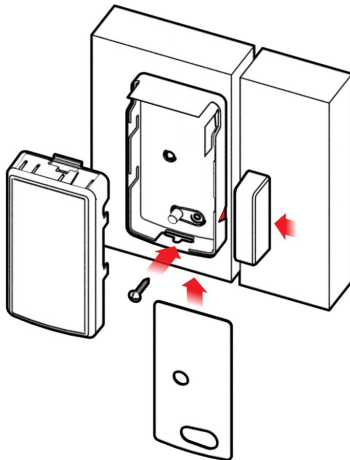

### Mounting Leak Detection Sensors

Install the water probe so the probe's metal pins are flat on the floor. Use the included screws to attach the probe in position on the floor or wall.

Mount the sensor using the adhesive pad and (optional) tamper screw.

If needed for better positioning, run the wire along pipes or around obstacles. Coil excess wire.

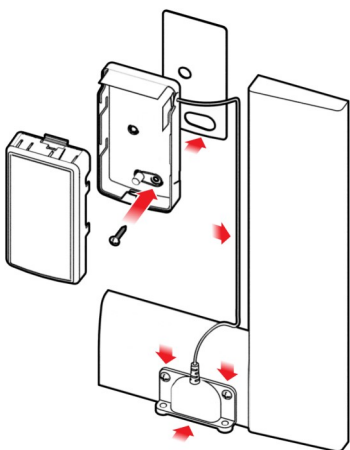

### Mounting the Air Temperature Humidity Sensor

To mount the Air Temperature Humidity Sensor:

1. Turn the mounting bracket counterclockwise to remove it from the sensor.
2. Secure the bracket with the enclosed screws.
3. Put the sensor on the mounting bracket and turn clockwise.

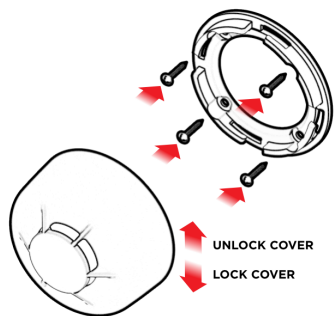

## Viewing Sensor Data

To view sensor data:

- Log into the console at <https://console.radiobridge.com>. The Dashboard appears showing the sensors you added.